

SCHEDULE OF DOOR & WINDOW:-

MARK	SIZE	DESCRIPTION
D1	1000X2100	FULLY PNL
D3	750X2100	FULLY PNL
W	1800X1200	SLIDING WINDOW
W1	1500X1200	SLIDING WINDOW
W2	1000X1200	SLIDING WINDOW
V	600X450	UPVC MOVABLE VENTILATOR
V1		VENTILATOR FOR STAIR CASE.

PROJECT NAME:-
PLAN OF PROPOSED (G+B) NINE STORED RESIDENTIAL BUILDING (BLOCK-02) OF SHRI. RAMPRASAD ADHIKARY, S/O MR. PARIMAL ADHIKARY, (DEVELOPED BY THREE BUILDERS)
L.R. PLOT NO-208,209,210,212/707, J.L.NO-210,MOUZA-SANBANDA, P. S BANKURA, DIST-BANKURA.WEST BANGAL-722180.

- NOTES :-
- ALL DIMENSIONS ARE IN M.M. AND ALL LEVEL ARE IN M.
 - WRITTEN DIMENSIONS MUST BE FOLLOWED
 - ALL EXTERNAL WALLS 250TH. & INTERNAL WALLS 125THK. UNLESS OTHERWISE MENTIONED.
 - ALL MASONRY WORKS ARE BOUNDED BY CEMENT MORTAR (1:6) & (1:4).
 - EXTERNAL PLASTER IS 25THK. & INTERNAL PLASTER IS 12MM.THK.
 - ALL CONC. GRADE IS M25 & AND GRADE OF STEEL FE-500
 - 250THK. BRICK WORK IN 1:6 MORTAR
 - 125THK. & 75THK. BRICK WORK IN 1:4 MORTAR
 - 150 WIDE SURFACE DRAIN SHOULD BE PROVIDED ALL ROUND THE BUILDING.
 - 25% OF THE BUILDING TO BE CONSTRUCTED USING FLY-ASH BRICKS

AREA CALCULATION:-

LAND AREA (SQ.M.)	PLINTH AREA (SQ.M.)	
	FLOOR	BLOCK-2
3460.75	GROUND FLOOR	504.41
	FIRST FLOOR	523.05
	SECOND FLOOR	523.05
	THIRD FLOOR	523.05
	FOURTH FLOOR	523.05
	FIFTH FLOOR	523.05
	SIXTH FLOOR	523.05
	SEVENTH FLOOR	523.05
	EIGHTH FLOOR	523.05
TOTAL	4688.81	

GROUND COVERAGE = 40.88 %
F.A.R = 2.23
NO. OF FLATS = 48
NO. OF CAR PARKING = 34

OFFICE USE:-
(Signature)
District Engineer
Bankura Zilla Panchayat

TITLE:-
SECTIONAL VIEW (BLOCK-02), TYPICAL FLOOR PLAN (BLOCK-02), ROOF PLAN (BLOCK-02), DETAILS OF SEPTIC TANK, DETAILS OF RAIN WATER SOAK PIT.

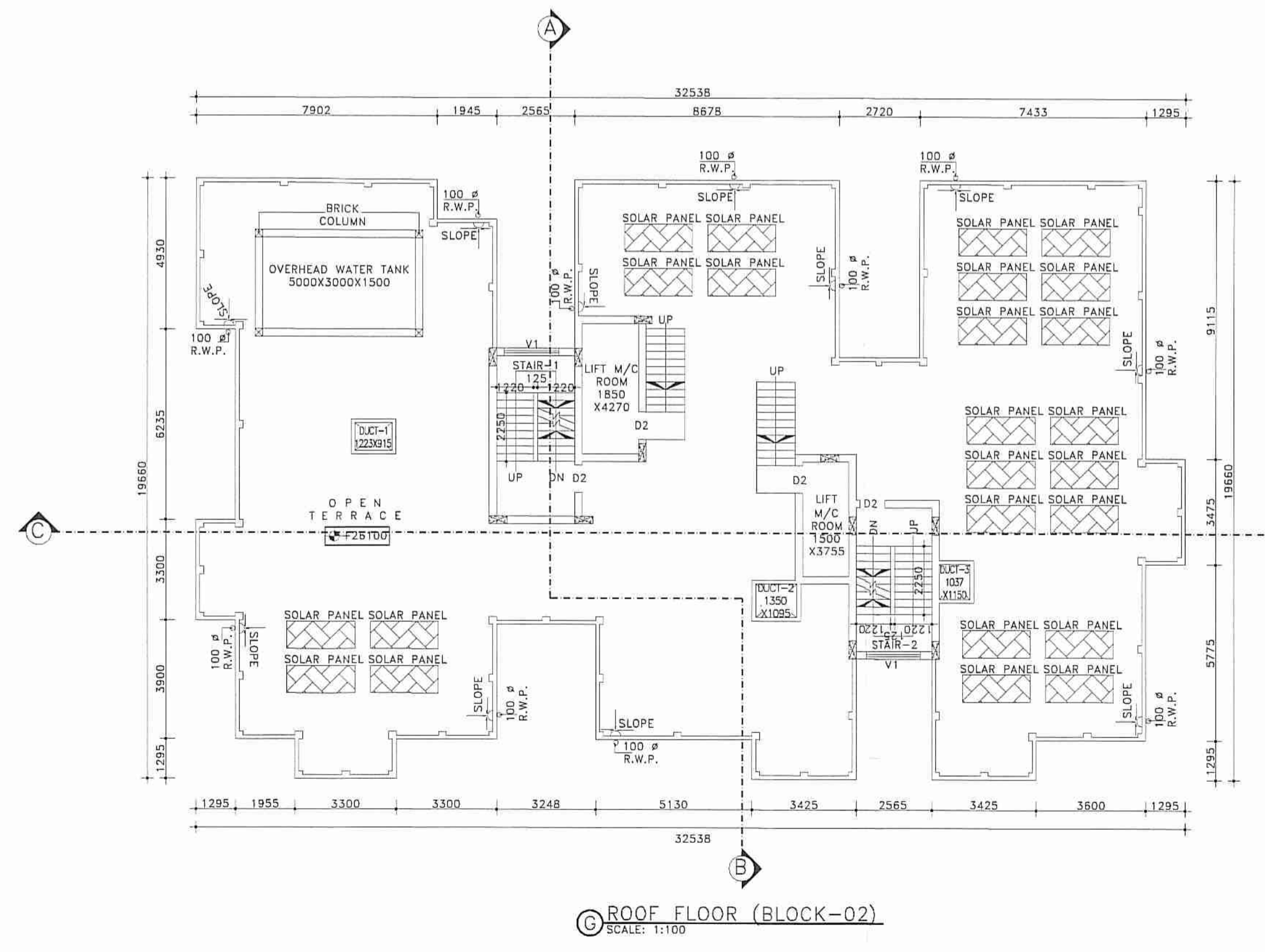
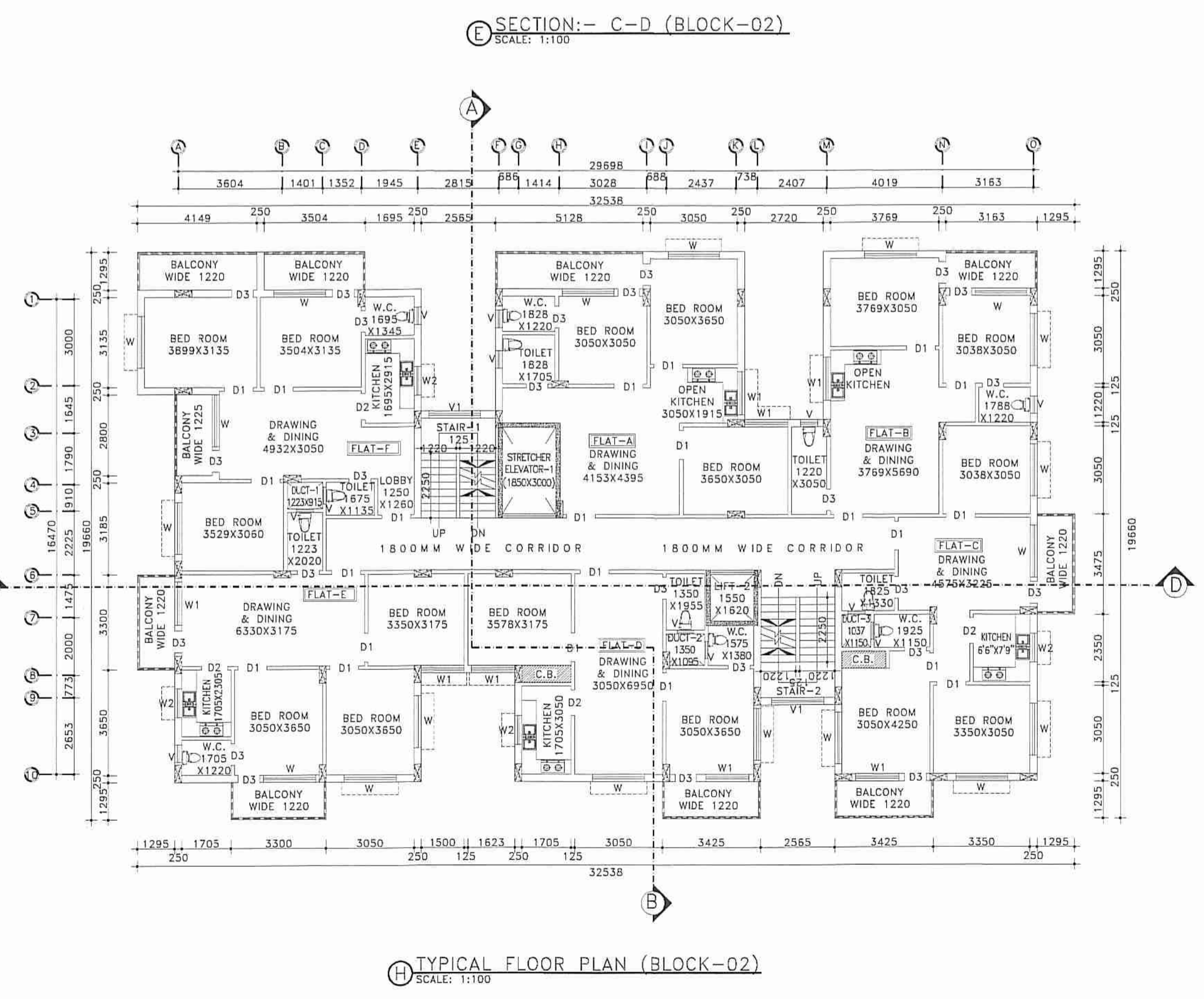

SIGNATURE OF ARCHITECT:-
(Signature)
VAISHAL KUMAR ATHALYE
CONSULTING ARCHITECT
CA/2018/101108

SIGNATURE OF DEVELOPER/OWNER:-
(Signature)
SHREE BUILDERS
Kuntal Bhattacharya
Partners

SIGNATURE OF STRUCTURAL ENGINEER:-
(Signature)
Hiron Ghosh
Structural Engineer
Lic No. - L.B.PM/163/AMC-DMC/DPD/165
DCE, B.TECH. G.I.D.S. Durgapur-16
Contact No:- 9532323331

SIGNATURE OF GEO-TECHNICAL ENGINEER:-
(Signature)
MANOJ KUMAR
Civil & Geotechnical Engineer
CE, MIES - LM4299
Lic. No. - LBPM/162/AMC
G.I.D.S., Durgapur - 16

DATE: 22.10.2021
SCALE: 1:100, N.T.S.
REV-00
PROJECT NAME:-
SHEET NO:-GDS/P&R/ARCH/(BL-2)-02/03